

# Kubota



## KUBOTA DIESEL ZERO-TURN MOWER

# ZD

## ZD326

Kubota's ZD-326 zero-turn mower deliver the performance and high quality demanded by commercial operators.







**Cutting grass is the commercial operator's livelihood. And Kubota's ZD326 delivers the power, durability, and performance professionals want.**



Day in and day out, you need a professional turf mower that handles non-stop use—a mower that's maneuverable, cost effective, and loaded with the features to make your job easier. That's why Kubota developed the ZD326 zero-turn commercial mower—to deliver the results your business demands. The ZD326 offers a state-of-the-art Kubota diesel engine, a high-capacity HST transmission, a deep mower deck, and an ultra-comfortable operating area. In short, the ZD326 delivers.



# KUBOTA DIESEL ENGINE

Kubota diesel engines are known for their durability, high performance, energy efficiency and reliability. Kubota diesels offer many advantages over gasoline engines: as much as 30%\* more fuel efficiency, higher torque, fewer emissions and quieter operation, among others. Kubota engines can aggressively take on heavy mowing jobs for extended periods. And, whether it's our 26-PS engine, it will exceed the high expectations of the commercial landscaper.



## DUAL-ELEMENT AIR CLEANER

Kubota ZD326 mowers come equipped with a dual-element air cleaner which features a vacuum sensor to tell you when to service the air cleaner.



## LARGE FUEL TANK

Kubota has increased the fuel capacity for the ZD326 to 45 Liter by including two fuel tanks. This allows the operator to work longer and more efficiently without stopping to refuel. This feature is especially handy for those big jobs.



## LARGE RADIATOR

The radiator on the ZD326 mower is built to improve cooling performance and prevent the engine from overheating.

## KUBOTA DIESEL ZERO-TURN MOWER

# ZD326

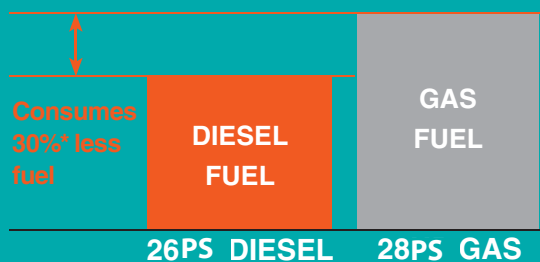

\*Results vary by the engine settings, grass conditions, terrain, etc.

## DURABILITY

The ZD-300 series is extremely reliable, thanks in no small part to the new Kubota integral-type HST transmission system. It's designed with strong components and the high capacity an HST system needs to assure outstanding commercial mowing performance and productivity.

1. Wet-type hydraulic PTO clutch; 30% increase in transfer capacity
2. 120% increase in HST capacity
3. Strong casting rear shaft cover
4. Replaceable, large suction paper cartridge filter
5. External, gear-hydraulic charge pump
6. Extended rear tire axle for added strength
7. Enclosed hydraulic control valves for mower deck lifting
8. Durable copper metal cylinder block
9. Wet-type multi-disk brake (on parking brake)

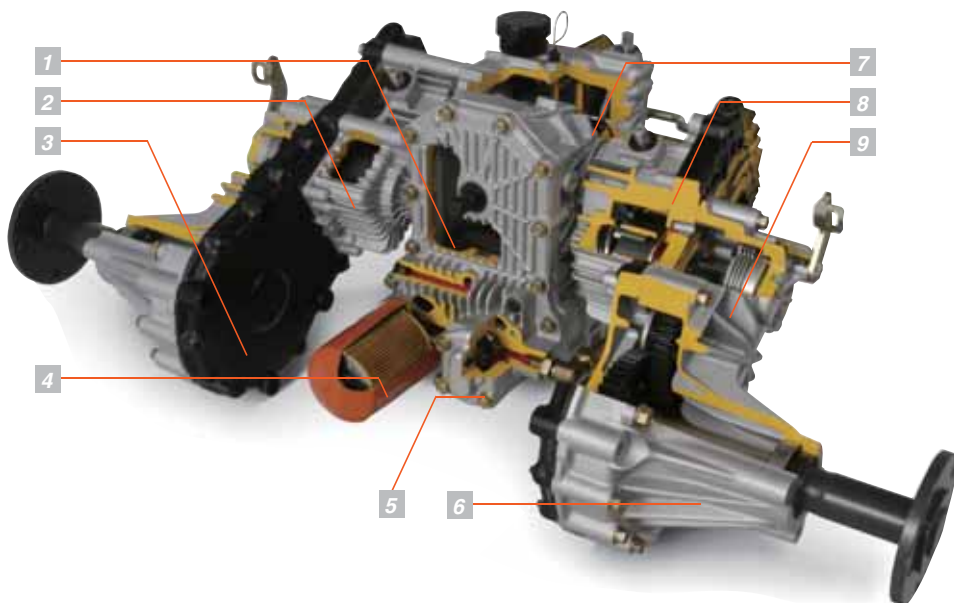

# COMFORT

The ZD-300's comfortable operator platform boasts a wide array of features designed to make work easier. Wider control levers and a full-flat operator platform allow greater legroom; the angled panel helps to prevent glare for easier indicator and control viewing. In addition, the ZD-300 offers an ergonomic, 4-control adjustable seat to prevent fatigue and a conveniently placed cup holder so you can quench your thirst on the job.

## HIGH-BACK DELUXE SUSPENSION SEAT

Outstanding comfort is what you'll feel with Kubota's standard deluxe link-type suspension seat with adjustable armrests. The extra-wide seat features weight adjustment, adjustable armrests, and much more to give the operator a custom fit.



LUMBAR SUPPORT



SUSPENSION SEAT  
ADJUSTMENT  
LEVER



RECLINING DIAL



PARKING BRAKE  
(Hands-free)

HANDS-FREE  
HYDRAULIC  
DECK LIFT

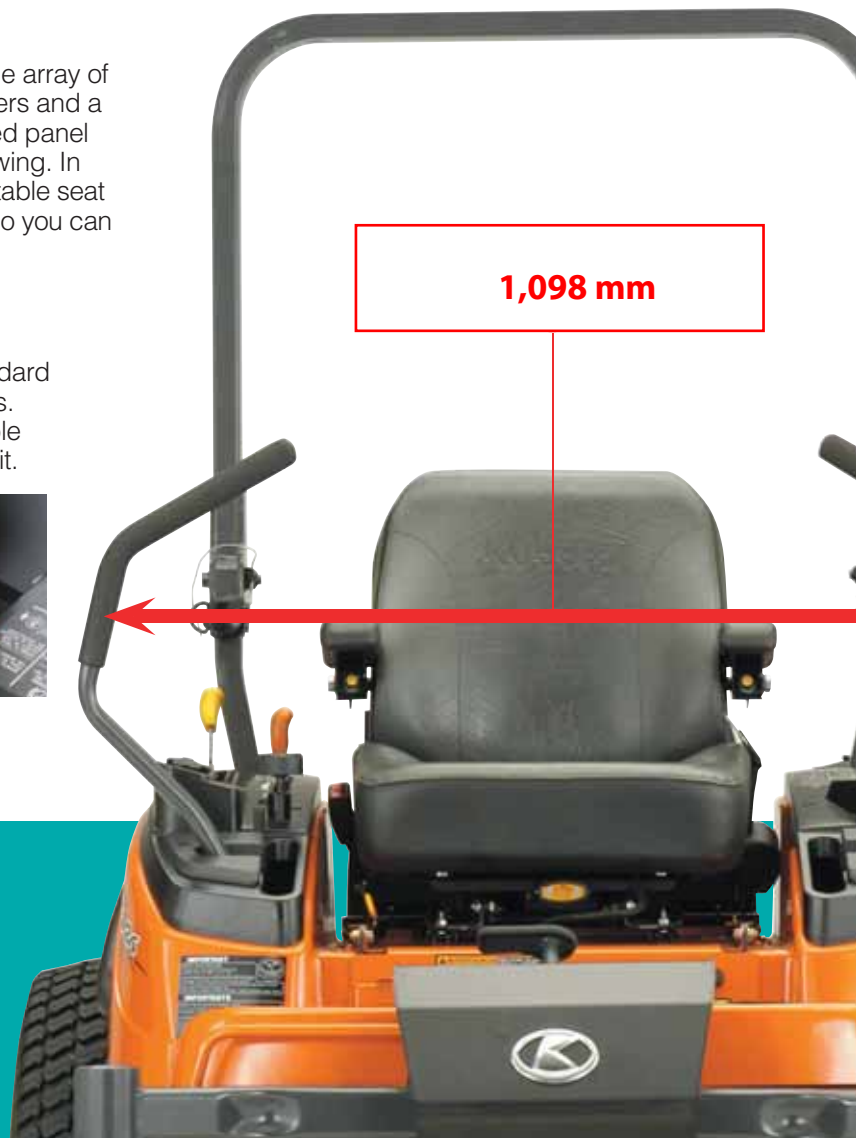

1,098 mm

# MOWER DECK

## PRO COMMERCIAL MOWER DECK

To ensure superior cutting performance, even at faster speeds, our newly developed, deeper mower deck utilizes a flat design and our unique new baffling system, which forces grass through all three cutting blades. And, to meet the needs of varying job sizes, the ZD326 mower deck is available in three sizes: 60".



**NEW**

140 mm Deep  
Mower Deck



## NEW BAFFLE DESIGN

The ZD-300's new baffle design improves air flow to discharge grass clippings, optimizing cutting performance.

## FLEXIBLE DISCHARGE CHUTE

The mower deck's discharge chute is crafted from a flexible-but-sturdy material, which helps considerably reduce damage to brush and landscaping.

## ANTI-OVERFLOW SYSTEM

Kubota has enhanced the edges of the mower deck to reduce grass spillage and help keep lawns tidy, particularly in dry conditions.



# MAINTENANCE

Kubota has made maintenance of the ZD-300 unbelievably simple. Thanks to a unique maintenance lift system, a tilt-up seat for quick and thorough access to the HST, and a new maintenance hatch on the full-flat platform for easy access to the PTO shaft, work can be completed on every key component without difficulty.

## MAINTENANCE LIFT

For routine maintenance underneath the mower, Kubota's unique two-pin, tilt-up, lift feature allows the front of the ZD-300 to be easily raised without having to remove the mid-mount mower. The system includes locks for the front tires to ensure safety. It's like having a built-in jack right there when you need it.



RADIATOR SCREEN



AIR CLEANER INDICATOR



ENGINE COOLANT ALERT



TIE DOWN



MULCHING MOWER

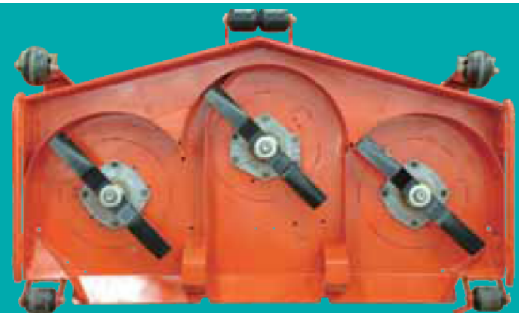

REAR DISCHARGE MOWER



## BLADE SHAFT BEARING AND BELT PULLEY

Blade shaft bearing and the blade gear components are extremely strong.



MOWER DECK WITH MULCHING KIT  
(AVAILABLE AS ACCESSORY)



## EXACT CUTTING HEIGHT ADJUSTMENT

Cutting height can be easily changed, from 25 - 127 mm with 6 mm increments, with the adjustment dial. Located conveniently on the control panel, the adjustment dial is easily accessed to increase or decrease cutting height.



## MOWER LIFT LINK

The ZD-300 mowers feature stronger lift link components, including an enhanced lift shaft, a thicker lift arm, and a wider shaft diameter.

# Specifications

Model			ZD326	
			ZD326-60-EU/ZD326-60R-EU	
Engine	Model		Kubota D1005	
	Type		Diesel, liquid-cooled (3 cyl.)	
	Max. horsepower (Gross)		19.1 kW (26 PS)	
	Total displacement		1001cc	
	Starting system		Key switch - super glow	
Dimensions	Overall length		2220 mm	
	Overall width	(w/ mower)	1854 mm (Side Discharge Mower) / 1604 mm (Rear Discharge Mower)	
		(w/o mower)	1460 m	
	Overall height	(w/ ROPS upright)	1915 mm	
		(w/ ROPS folded)	1555 mm	
Wheel base			1410 mm	
Tread	Front		975 mm	
	Rear		1150 mm	
Tyre size	Front		15 × 6.0-6 Non Flat	
	Rear		26 × 12.0-12	
Weight (w/ mower) (without fuel)			771 kg	
Transmission system			2-HST w/ Gear	
Speed control			2-hand lever	
Travel speed range	Forward		0-15.0 km/h	
	Reverse		0-8.3 km/h	
Brake type			Wet multi disks, foot operated	
PTO	Type		Shaft drive	
	Clutch type		Wet multi disk	
	PTO brake		Wet single disk	
Mower deck	Model		RCK60P-326Z-EU/RCK60R-326Z-EU	
	Mower lift system		Hydraulic	
	Mower deck type		Fabricated deck	
	Deck depth		140 mm	
	Deck steel thickness		4.6 mm, 4.2 mm	
	Anti-scalp roller		Swivel	
	Cutting width of mower		60 in.	
	Number of blades		3 blades	
	Cutting height		25 - 127 mm / Abstufung 6.3 mm	
	Mounting system of mower		Parallel linkage	
	Blade tip speed (max.)		18100 FPM	
Seat adjustment			One touch system (weight, armrests, reclining, and lumbar support)	
Step deck			Full flat	
Engine stop system			Key stop	
Fuel tank capacity			45 ltrs.	
Battery			12 Volts, 51R, 450CAA@0° F, 70 min. RC.	
Alternator capacity			14 Volts 14 Amps	
Water temperature indicator			Standard	
Hour meter			Standard	
Fuel gauge			Electric	

©2008 Kubota Corporation



**KUBOTA (DEUTSCHLAND) GmbH**

Senefelder Straße 3-5, 63110 Rodgau/Nieder-Roden  
 Telefon 06106/873-0 Telefax 06106/873-197 E-mail info@kubota.de  
[www.kubota.de](http://www.kubota.de)